

NOTICE!!

These documents have been scanned!

Do not place un-scanned documents beneath this notice!

Do not remove this notice from this file!

GPO Jacket No. 560-102
Print Order 61540
Rise Business Services, LLC
Job=AZ15 5/1/2019



Box Number= AZ15012



Claim Begin-End: AMC440737-AMC440737

1 Initial Receipt



AZ15012-14

AMC440519-AMC441162

United States Department of the Interior
Bureau of Land Management
 DIV OF LANDS, MINRLS & ENERGY
 ONE N CENTRAL AVE
 PHOENIX, AZ 85004 -4427
 Phone: 602-417-9200

Receipt

No: 3735312

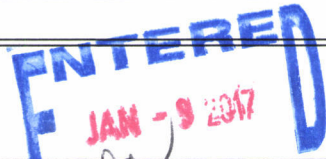
Transaction #: 3840698	
Date of Transaction: 01/03/2017	
CUSTOMER:	
PATRICK FLANAGAN 4473 OLSON LAKE TRL N LAKE ELMO,MN 55042-8527 US	

LINE #	QTY	DESCRIPTION	REMARKS	UNIT PRICE	TOTAL
1	1.00	LOCATABLE MINERALS / MINING CLAIMS-NEW,UNADJUD, ONE OR MORE AUTH NOS / NEW MINING CLAIM PROCESSING FEE CASES: AMC440737/\$20.00		- n/a -	20.00
2	1.00	LOCATABLE MINERALS / MINING CLAIMS-NEW,UNADJUD, ONE OR MORE AUTH NOS / NEW MINING CLAIMS LOCATION FEE CASES: AMC440737/\$37.00		- n/a -	37.00
3	1.00	LOCATABLE MINERALS / MINING CLAIMS-NEW,UNADJUD, ONE OR MORE AUTH NOS / NEW MINING CLAIMS MAINTENANCE FEE CASES: AMC440737/\$155.00		- n/a -	155.00
4	1.00	LOCATABLE MINERALS / MINING CLAIMS-NOT NEW-UNADJUD,ONE AUTH NO. ONLY / MINING CLAIM MONEY RECEIVED CASES: AMC440737/\$155.00	ADDITIONAL PLACER FEES	- n/a -	155.00
TOTAL:					\$367.00

PAYMENT INFORMATION			
1	AMOUNT:	367.00	POSTMARKED: N/A
	TYPE:	CHECK	RECEIVED: 01/03/2017
	CHECK NO:	8628	
	NAME:	FLANAGAN, DR PATRICK 4473 OLSON LAKE TRL N	

	LAKE ELMO MN 55042-8527 US
--	----------------------------

REMARKS

This receipt was generated by the automated BLM Collections and Billing System and is a paper representation of a portion of the official electronic record contained therein.

NOTICE!!

These documents have been scanned!

Do not place un-scanned documents beneath this notice!

Do not remove this notice from this file!

GPO Jacket No. 560-102
Print Order 61540
Rise Business Services, LLC
Job=AZ15 5/1/2019



Box Number= AZ15012



Claim Begin-End: AMC440737-AMC440737

2 Correspondence



AZ15012-14 AMC440519-AMC441162

**NO
DOCUMENTS
FOUND**

NO DOCUMENTS FOUND
NO DOCUMENTS FOUND

NOTICE!!

These documents have been scanned!

Do not place un-scanned documents beneath this notice!

Do not remove this notice from this file!

GPO Jacket No. 560-102
Print Order 61540
Rise Business Services, LLC
Job=AZ15 5/1/2019



Box Number= AZ15012



Claim Begin-End: AMC440737-AMC440737

3 Transfers



AZ15012-14 AMC440519-AMC441162

**NO
DOCUMENTS
FOUND**

NO DOCUMENTS FOUND
NO DOCUMENTS FOUND

NOTICE!!

These documents have been scanned!

Do not place un-scanned documents beneath this notice!

Do not remove this notice from this file!

GPO Jacket No. 560-102
Print Order 61540
Rise Business Services, LLC
Job=AZ15 5/1/2019



Box Number= AZ15012



Claim Begin-End: AMC440737-AMC440737

4 Annual Filings



AZ15012-14

AMC440519-AMC441162

UNITED STATES
DEPARTMENT OF THE INTERIOR
BUREAU OF LAND MANAGEMENT

MAINTENANCE FEE WAIVER CERTIFICATION

SEE INSTRUCTIONS ON PAGE 2

489
AMC 430219
446737
FORM APPROVED
OMB NO. 1004-0114
Expires: January 31, 2020

1. This small miner waiver is filed for the assessment year beginning on September 1, 2018 and ending on September 1, 2019.
2. The undersigned and all related parties owned ten or fewer mining claims, mill, or tunnel sites located and maintained on Federal lands in the United States of America on September 1, 2018.
3. The undersigned have performed the assessment work required by law for each mining claim listed prior to filing this waiver and understand that by filing this form, the undersigned must file an affidavit of assessment work with the Bureau of Land Management (BLM) by the December 30th following the filing of this waiver.
4. The undersigned understand that if the assessment work obligation has not yet come due under 30 U.S.C. 28 (for those claims in their first assessment year only), a notice of intent to hold reciting this condition must be recorded by the December 30th following the filing of this waiver.
5. The undersigned understand that mill and tunnel sites may also be listed on this waiver and be waived from payment of the maintenance fee, and that a notice of intent to hold for these sites is required to be filed with the BLM by the December 30th following the filing of this waiver.
6. The undersigned understand and acknowledge that pursuant to 43 U.S.C. 1212 and 18 U.S.C. 1001, the filing or recording of a false, fictitious, or fraudulent document with the BLM may result in a fine of up to \$250,000, a prison term not to exceed five years, or both.
7. The mining claims, mill or tunnel sites for which this waiver from payment of the maintenance fees is requested are:

CLAIM OR SITE NAME	BLM RECORDATION SERIAL NUMBER
1. Red Cloud 3	AMC 430220 (913
2. Outlaw	AMC 440737
3.	
4.	
5.	
6.	
7.	
8.	
9.	
10.	

RECEIVED
BLM AZ STATE OFFICE
2018 AUG 28 PM 12:59
PHOENIX, ARIZONA

The owner(s) (claimants) of the above mining claims and sites are:

Patrick Flanagan
(Owner's Name - Please Print)
820 Hillside Trail
(Owner's Mailing Address)

Patrick Flanagan
(Owner's Signature)
Hudson WI 54016
(City) (State) (Zip Code)

Anne Flanagan
(Owner's Name - Please Print)
820 Hillside Trail
(Owner's Mailing Address)

Anne Flanagan
(Owner's Signature)
Hudson WI 54016
(City) (State) (Zip Code)

(Owner's Name - Please Print)
(Owner's Mailing Address)

(Owner's Signature)
(City) (State) (Zip Code)

(Owner's Name - Please Print)
(Owner's Mailing Address)

(Owner's Signature)
(City) (State) (Zip Code)

(Continued on page 2)

BY: 

SEP 10 2018

NWV

P Flanagan
820 Hillside Trail
Hudson, WI

RECEIVED
BLM AZ STATE OFFICE

2018 AUG 28 P 12:59

PHOENIX, ARIZONA

54016

SAINT PAUL MN 550

21 AUG 2018 PM 2 L



Bureau of Land Management
Div. of Lands, MINRES + Energy
One N. Central Ave
Phoenix, AZ

85004-4427

BE00434427 CO41

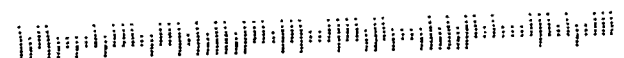

Run Date: 09/05/17

Run Time: 02:33 PM

**DEPARTMENT OF THE INTERIOR
BUREAU OF LAND MANAGEMENT
MINING CLAIMS**

MC Maintenance Fees Paid Through the BLM Pay Portal

CBS Receipt: 3965403

Printed For Lead File # **AMC440737**

Agency Tracking ID: 1504039133

Assessment Year: 2018

Number of BLM Serial Nr: 2

Paid On: 08/29/2017

Total Amount Paid: \$465.00

Claim Name	BLM Serial No	Lead File No	Amount Paid
RED CLOUD NO 3	AMC430220	AMC430219	\$155.00
OUTLAW	AMC440737	AMC440737	\$310.00

United States Department of the Interior
Bureau of Land Management
 BUSINESS & SUPPORT SVCS DIV
 ONE N CENTRAL AVE SUITE 800
 PHOENIX, AZ 85004 -4427
 Phone: 602-417-9200

Receipt

No: 3965403

Transaction #: 4075279	
Date of Transaction: 08/29/2017	
CUSTOMER:	
	PATRICK J FLANAGAN 820 HILLSIDE TRL HUDSON, WI 54016 US

LINE #	QTY	DESCRIPTION	REMARKS	UNIT PRICE	TOTAL
1	1.00	LOCATABLE MINERALS / MINING CLAIMS- NOT NEW-UNADJUD, ONE AUTH NO. ONLY / MINING CLAIM MONEY RECEIVED CASES: AMC430220/\$465.00		- n/a -	465.00
TOTAL:					\$465.00

PAYMENT INFORMATION				
NOTE: Items will appear on credit card statement as "BLM O Mining Claim".				
1	AMOUNT:	465.00	POSTMARKED:	N/A
	TYPE:	CREDIT CARD	RECEIVED:	08/29/2017
	NAME:	PATRICK J FLANAGAN 820 HILLSIDE TRL HUDSON WI 54016 US		
	CARD NO:	XXXXXXXXXXXX1906	AUTH CODE:	000532
	NAME ON CARD:	PATRICK J FLANAGAN		
	EXPIRES:	01/2019		
	SIGNATURE:			

REMARKS

This receipt was generated by the automated BLM Collections and Billing System and is a paper representation of a portion of the official electronic record contained therein.

NOTICE!!

These documents have been scanned!

Do not place un-scanned documents beneath this notice!

Do not remove this notice from this file!

GPO Jacket No. 560-102
Print Order 61540
Rise Business Services, LLC
Job=AZ15 5/1/2019



Box Number= AZ15012



Claim Begin-End: AMC440737-AMC440737

5 Miscellaneous



AZ15012-14

AMC440519-AMC441162

**NO
DOCUMENTS
FOUND**

NO DOCUMENTS FOUND
NO DOCUMENTS FOUND

NOTICE!!

These documents have been scanned!

Do not place un-scanned documents beneath this notice!

Do not remove this notice from this file!

GPO Jacket No. 560-102
Print Order 61540
Rise Business Services, LLC
Job=AZ15 5/1/2019



Box Number= AZ15012



Claim Begin-End: AMC440737-AMC440737

6 Location Notices-Amendments and Supporting Documents



AZ15012-14

AMC440519-AMC441162

MINING CLAIM STATUS REPORT

Data Entered: 9 Jan 17

MTP Checked By: [Signature]
GEO Checked By: [Signature]

LEAD SERIAL NUMBER: AMC 440137 thru AMC _____

NUMBER OF CLAIMS & TYPE:

1 LODE

PLACER

ASSOCIATION PLACER

MILL SITE

TUNNEL SITE

CHARGES:

Location Fee @ \$37 = \$ 37

Processing Fee @ \$20 = \$ 20

Maintenance Fee @ \$155 = \$ 155

Add'l Maint Fee for Assoc Placer = \$ 155

SUBTOTAL \$ _____

Other Fees \$ _____

Other Fees \$ _____

TOTAL \$ 367

TOTAL ACREAGE: 40 Per Claim
(Placer Only)

NUMBER OF LOCATORS: 2

DOCUMENTS RECEIVED VIA : Over-the-Counter ☒ Mail ☐ **TIMELY FILED:** Yes ☒ No ☐

* Accepted as mail

LEGAL DESCRIPTION: T 7N R 3W SEC 5
T _____ R _____ SEC _____
T _____ R _____ SEC _____
T _____ R _____ SEC _____
T _____ R _____ SEC _____

BLM ☒ FOREST SERVICE ☐ SUBJ TO PL 359: Yes ☐ No ☐
WILDERNESS AREA ☐

SPLIT ESTATE: N/A ☐ SX ☐ PX ☐ OTHER ☐
SRHA ☐ Was proper Notice filed if located on SHRA Land? Yes ☐ No ☐

RECONVEYED MINERALS ON BLM LAND REQUIRE OPENING ORDER FROM 1944 TO 1993:

Open to Entry On _____ N/A ☐

COMMENTS/STATUS: VOID ☐ PARTIALLY VOID ☐ PVT MINERALS ☐ WITHDRAWN LANDS ☐
OTHER ☐

[] Claimant acknowledges that portions of the following claim(s) site(s) may be void or voidable.

Printed Name of Claimant _____ Signature of Claimant _____

*****FINAL ADJUDICATION*****

DATE 7/28/2017 INITIALS [Signature]

AHC440737

RECEIVED
BLM AZ STATE OFFICE

2017 JAN - 3 A 11:11

PHOENIX, ARIZONA

BLM
Date
Stamp

LOCATION NOTICE FOR PLACER MINING CLAIM

☐ Amendment BLM Serial # _____

NOTICE IS HEREBY GIVEN that the Outlaw

_____ placer mining claim has been located by
Patrick Flanagan + Anne Flanagan whose current mailing

address is 4473 Olson Lake Tr N
Lake Elmo, MN 55042

The general course of this claim is _____ and it is situated in Yavapai

County, Arizona. This claim is 1320 feet in length and 1320 feet in width.

40 Total Claim Acreage. This claim runs from the location monument on which this location notice is posted at the NW corner of the claim approximately 20 feet in a east direction to the N S end line and 20 feet in a south direction to the E W end line. This claim is marked by four monuments, one at each corner of the claim.

The location monument on which this notice is posted is situated within Section 5, Township

7 N, Range 3 W, Gila Salt River Base and Meridian, Arizona. This claim encompasses portions of the following legal subdivision(s) if located by legal subdivision or the following quarter section(s), section(s), Township(s) and Range(s) SESE 1/4 of SE 1/4 sec 5

_____, Gila Salt River Base and Meridian, Arizona.

The locality of this claim with reference to some natural object or permanent monument and additional information (if any) concerning its locality are as follows: _____

_____ The above information is shown on the attached map.

DATED AND POSTED on the ground this 12 day of October, 2016.

☒ LOCATOR(s) ☐ AGENT

Print Name(s) Patrick Flanagan Anne Flanagan

Signature(s) Patrick Flanagan Anne H. Flanagan

Form MCF102
Revised July 2014

MINING CLAIM MAP

Lode () Placer (x)
Millsite ()

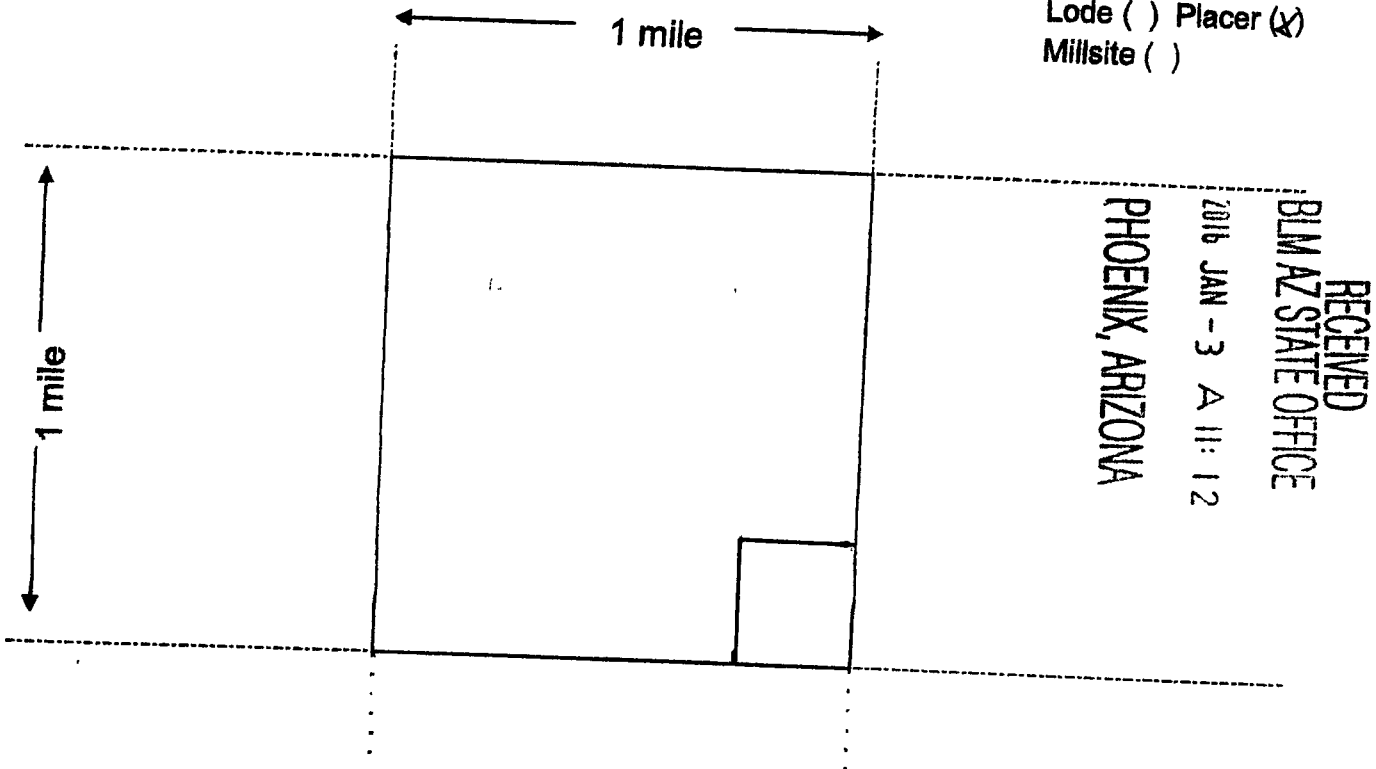

RECEIVED
BLM AZ STATE OFFICE
2016 JAN - 3 A 11:12
PHOENIX, ARIZONA

Scale: 1" = 2000 feet



- The above map depicts the outlaw mining claim, which is located in Section (s) 5, Township 7 N, Range 3 W, Gila and Salt River Base and Meridian, Yavapai County, Arizona. Total claim acreage is 40 acres
- The type of corner and location monuments used are as follows: Wooden Posts
- The bearings and distances in degrees and feet between claim corners and to a public land survey monument are as depicted on the map.
- If the claim is a placer or millsite claim with exterior limits conforming to legal subdivisions of the public survey, provide a legal description of the claim _____

Form MCF100a
Revised July 2014

This form is available from the Arizona Geology Survey and may be reproduced.

AHC440737

RUN TIME: 08:16 AM

**DEPARTMENT OF INTERIOR
BUREAU OF LAND MANAGEMENT**

**RUN DATE: 01/09/2017
Page 1 of 1**

Input Parameters for Geographic Report with Land

System Id = CR

Admin State = AZ

Geo State =

Casetype Begins With

Case Disp Txt = AUTHORIZED, CANCELLED, EXPIRED, PENDING, REJECTED, RELINQUISHED, WITHDRAWN

Mer Twp Rng =

Section =

Mtrs = 14 0070N 0030W 005, 14 0070N 0030W 999

Commodity =

Commodity Txt =

Pending Org =

Pend Org Decode =

Total Rows Returned: 0

**NO WARRANTY IS MADE BY BLM FOR USE OF THE DATA
FOR PURPOSES NOT INTENDED BY BLM**

MARICOPA/YAVAPAI COUNTY

[illegible]

FOR ORDERS AFFECTING DISPOSAL OR USE OF
UNIDENTIFIED LANDS WITHDRAWN FOR CLASSIFICATION,
MINERALS, WATER AND/OR OTHER PUBLIC PURPOSES,
REFER TO INDEX OF MISCELLANEOUS DOCUMENTS

MDS 253 NE
254 NW

SCALE in chains

WARNING STATEMENT
This plot is the Bureau's Record of Title, and should be used only as a graphic display of the township survey data. Records hereon do not reflect title changes which may have been affected by lateral movements of rivers or other bodies of water. Refer to the cadastral surveys for official survey information.

CURRENT TO	BT	
1-26-2005	PV	T <u>7 N</u>
		R <u>3 W</u>